

LAG

ADINYL

POLIAMMIDE 6 + POLIURETANO COLATO

- Rivestimento in poliuretano colato, durezza 95±3 Shore A.
- Nucleo in poliammide 6 di prima scelta.
- Elevata portata, scorrevolezza, silenziosità; massima resistenza agli urti, all'abrasione e alle sostanze corrosive; facilità di pulizia.
- Temperatura di impiego: -30°C / +80°C.
- Mozzo con: cuscinetti a sfere di precisione, schermati; cuscinetto a rullini standard o inox; foro passante.



POLYAMIDE 6 + CAST POLYURETHANE

- Cast polyurethane coating, hardness 95±3 Shore A.
- Core in high quality polyamide 6.
- High load capacity; smooth and noiseless running; high resistance to shocks, abrasion and corrosion; easy to clean.
- Temperature range: -30°C / +80°C (-22°F / +176°F).
- Hub with: shielded precision ball bearings; standard or stainless steel roller bearing; plain bore.

POLYAMID 6 + POLYURETHAN (GEGOSSEN)

- Beschichtung aus Guss-Polyurethan, Härte 95±3 Shore A.
- Radkern aus Polyamid 6 - 1. Wahl.
- Hohe Tragkraft; niedriger Rollwiderstand; geräuschloser Lauf; hohe Stossfestigkeit; abrieb- und korrosionsfest; leichte Reinigung
- Arbeitstemperatur: -30°C / +80°C.
- Lagerung: abgeschirmte Präzisions-Rillenkugellager; standard oder rostfreies Rollenlager; Gleitlager.

POLYAMIDE 6 + POLYURETHANE COULÉ

- Bandage en polyuréthane coulé, dureté 95±3 Shore A.
- Corps en polyamide 6 premier choix.
- Pour charges élevées; silencieuse; faible résistance au roulement; très élevée résistance aux chocs, à l'usure et à la corrosion; facilité de nettoyage.
- Température d'emploi: -30°C / +80°C (-22°F / +176°F).
- Moyeu avec: roulements à billes de précision protégés; roulement à rouleaux inox ou standard; alésage lisse.

POLIAMIDA 6 + POLIURETANO COLADO

- Revestimiento en poliuretano colado, dureza 95±3 Shore A.
- Núcleo en poliamida 6 de primera calidad.
- Para cargas elevadas, facilidad de rodadura, muy silenciosa; máxima resistencia a los golpes, a la abrasión y a las sustancias corrosivas; se limpia fácilmente.
- Temperatura de empleo: -30°C / +80°C (-22°F / +176°F).
- Cubo con: cojinetes a bolas de precisión, protegidos; cojinete a rodillos standard o inox; agujero liso.

D	80	100	100	125	125	150	175	200	200	225	225	275
E	24	30	40	30	40	40	40	50	50	50	50	60



CUSCINETTI A SFERE DI PRECISIONE - PRECISION BALL BEARINGS - PRÄZISIONS-RILLENKUGELLAGER
ROULEMENTS À BILLES DE PRECISION - COJINETES A BOLAS DE PRECISION

Art. N.	-	4501cc	4571cc	4502cc	4572cc	4574cc	4504cc	4507cc	4505cc	4509cc	4506cc	4508cc
X	-	80	80	100	100	125	150	175	175	200	200	250
d	-	15	15	15	15	15	20	20	25	20	25	25
s	-	35	35	35	35	35	47	47	52	47	52	52
t	-	12,2	12,2	12,2	12,2	12,2	17	17	17	17	17	17
V	-	38	38	38	38	48	44	54	56	54	56	56
L	-	40	40	40	40	50	50	60	60	60	60	60
M	-	47	47	48	48	50	63	69	69	63	71	82
Kg.	-	200	250	250	300	400	500	600	600	700	700	1000

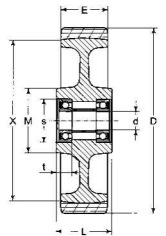

CUSCINETTO A RULLINI STANDARD O INOX - STANDARD OR STAINLESS STEEL ROLLER BEARING - STANDARD ODER ROSTFREIES ROLLENLAGER - ROULEMENT À ROULEAUX STANDARD OU INOX - COJINETE A RODILLOS STANDARD O INOX

Art. N.	-	4511	4561	4512	4562	4513	4514	4517	4515	4519	4516	4518	STANDARD INOX
Art. N.	-	4511/x	4561/x	4512/x	4562/x	4513/x	4514/x	4517/x	4515/x	4519/x	4516/x	4518/x	
d	-	15	15	15	15	20	20	20	25	20	25	25	
L	-	40	40	40	40	50	50	60	60	60	60	74	
M	-	37	47	38	48	43	49	55	55	57	57	68	
Kg.	-	200	250	250	300	400	500	600	600	700	700	1000	

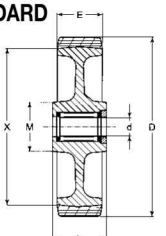

FORO PASSANTE - PLAIN BORE - GLEITLAGER - ALÉSAGE LISSE - AGUJERO LISO

Art. N.	4520	4521	4591	4522	4592	4523	4524	4527	4525	4529	4526	4528
d	10	15	15	15	15	20	20	20	25	20	25	25
L	28	40	40	40	40	50	50	60	60	60	60	74
M	22	28	29	29	29	36	37	44	44	46	46	55
Kg.	120	200	250	250	300	400	500	600	600	700	700	1000

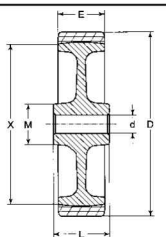

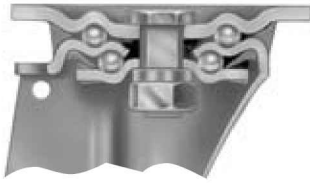

ADINYL + INOX40

INOX PESANTI - HEAVY STAINLESS - SCHWERLAST ROSTFREI - INOX LOURDES - INOX PESADOS







Art. N.+*FR*



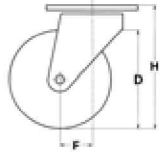

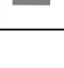

 D	100	100	125	125	150	175	200	225	
 E	40	40	40	40	40	40	50	50	



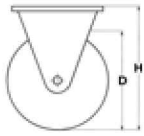

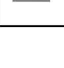

SUPPORTI GIREVOLI - SWIVEL CASTORS - LENKROLLEN - ROULETTES PIVOTANTES - CONJUNTOS GIRATORIOS

Art. N.	20628	20629	20633	20634	20641	20644	20646	20648		
d	15	15	15	15	20	20	20	25		
Art. N.	20653	20654	20658	20659	20666	20669	20671	20673		
d	15	15	15	15	20	20	20	25		

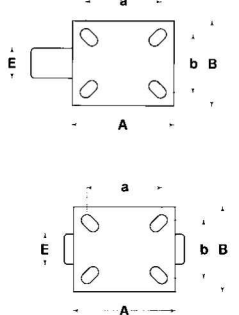
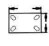
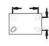
SUPPORTI FISSI - FIXED CASTORS - BOCKROLLEN - ROULETTES FIXES - CONJUNTOS FIJOS

Art. N.	20703	20704	20708	20709	20716	20719	20721	20723		
d	15	15	15	15	20	20	20	25		
Art. N.	20728	20729	20733	20734	20741	20744	20746	20748		
d	15	15	15	15	20	20	20	25		

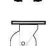
DATI TECNICI - TECHNICAL DATA - TECHNISCHE DATEN - DONNÉES TECHNIQUES - DATOS TECNICOS

 H	137	137	162	162	192	236	248	291	
 AxB	105x85	135x110	105x85	135x110	135x110	135x110	135x110	135x110	
 axb	80x60	105x80	80x60	105x80	105x80	105x80	105x80	105x80	
 g	8	10	8	10	10	12	12	12	
 F	42	42	42	42	49	60	60	69	
 U	50	50	50	50	50	60	60	60	
 FR	FR	FR	FR	FR	FR	FR	FR	-	
 Kg.	250	250	300	300	370	500	600	550	

LAG

ADINYL + INOX20

INOX - STAINLESS - ROSTFREI - INOX - INOX



pag. 17
Art. N.+*FR*



	D	80	100	100	125	125	125	150	150	175	200	
	E	24	30	40	30	30	30	40	40	40	50	

SUPPORTI GIREVOLI - SWIVEL CASTORS - LENKROLLEN - ROULETTES PIVOTANTES - CONJUNTOS GIRATORIOS

Art. N.	-	19105	19104	19106	19107	19108	19110	19111	19114	19117		
d	-	15	15	15	15	15	20	20	20	20		
Art. N.	19127	19130	19129	19131	19132	19133	19135	19136	19139	19142		
d	10	15	15	15	15	15	20	20	20	20		

SUPPORTI FISSI - FIXED CASTORS - BOCKROLLEN - ROULETTES FIXES - CONJUNTOS FIJOS

Art. N.	-	19155	19154	19156	19157	19158	19160	19161	19164	19167		
d	-	15	15	15	15	15	20	20	20	20		
Art. N.	19177	19180	19179	19181	19182	19183	19185	19186	19189	19192		
d	10	15	15	15	15	15	20	20	20	20		

SUPPORTI GIREVOLI A FORO - SWIVEL BOLT HOLE CASTORS - RÜCKENLOCH LENKROLLEN
ROULETTES PIVOTANTES A OEIL - CONJUNTOS GIRATORIOS CON TALADRO PASADOR

Art. N.	-	19205HB	19204HD	19206HB	-	19208HD	-	19211HD	19214HE	19217HE		
d	-	15	15	15	-	15	-	20	20	20		
Art. N.	19227HB	19230HB	19229HD	19231HB	-	19233HD	-	19236HD	19239HE	19242HE		
d	10	15	15	15	-	15	-	20	20	20		

DATI TECNICI - TECHNICAL DATA - TECHNISCHE DATEN - DONNÉES TECHNIQUES - DATOS TECNICOS

	H	106	128	129	154	160	160	181	181	216	240	
	AxB	102x83	102x83	102x83	102x83	102x83	135x110	102x83	135x110	135x110	135x110	
	axb	80x60	80x60	80x60	80x60	80x60	105x80	80x60	105x80	105x80	105x80	
	g	8	8	8	8	8	10	8	10	10	10	
	g		HB=10-12				HD=12-14			HE=12-14 / HF=16-18		
	F	33	37	46	40	49	49	51	51	57	59	
	U	40	40	50	40	50	50	50	50	60	60	
	FR	FR	FR	FR	FR	FR	FR	FR	FR	FR	FR	
	Kg.	120	150	250	150	250	250	250	250	370	370	

Attacco a perno filettato a richiesta - Threaded stem on request - Gewindestift auf Anfrage - Tige filetée sur demande - Espiga roscada sobre demanda.

ADINYL + P60

PESANTI - HEAVY - SCHWERLAST - LOURDES - PESADOS

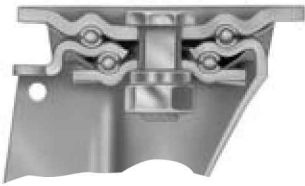

Art. N.+*FV*



Art. N.+*FR*



Art. N.+*PP*



	D	100	100	100	125	125	150	175	200	225	
	E	30	40	40	30	40	40	40	50	50	

SUPPORTI GIREVOLI - SWIVEL CASTORS - LENKROLLEN - ROULETTES PIVOTANTES - CONJUNTOS GIRATORIOS

Art. N.	19853	19854	19855	19859	19861	19866	19869	19871	19873		
d	15	15	15	15	15	15	20	20	20		
Art. N.	18878	19879	19880	19884	19886	19891	19894	19896	19898		
d	15	15	15	15	15	20	20	20	20		
Art. N.	19903	19904	19905	19909	19911	19916	19919	19921	19923		
d	15	15	15	15	15	20	20	20	20		

SUPPORTI FISSI - FIXED CASTORS - BOCKROLLEN - ROULETTES FIXES - CONJUNTOS FIJOS

Art. N.	19678	19680	19681	19684	19686	19691	19944	19946	19948		
d	15	15	15	15	15	15	20	20	20		
Art. N.	19703	19705	19706	19709	19711	19716	19969	19971	19973		
d	15	15	15	15	15	20	20	20	20		
Art. N.	19728	19730	19731	19734	19736	19741	19994	19996	19998		
d	15	15	15	15	15	20	20	20	20		

DATI TECNICI - TECHNICAL DATA - TECHNISCHE DATEN - DONNÉES TECHNIQUES - DATOS TECNICOS

Icon	H	137	137	137	163	163	194	237	249	292	
AxB	105x85	105x85	135x110	135x110	135x110	135x110	135x110	135x110	135x110	135x110	
axb	80x60	80x60	105x80	105x80	105x80	105x80	105x80	105x80	105x80	105x80	
g	8	8	10	10	10	10	12	12	12	12	
F	42	42	42	42	42	50	66	66	71	71	
U	50	50	50	50	50	50	60	60	60	60	
FR	FR	FR	FR	FR	FR	FR	FR/FV	FR/FV	FR/FV	FV	
PP	-	-	-	PP	PP	PP	PP	PP	PP	PP	
Kg.	200	250	250	200	300	400	500	600	600	700	

LAG

ADINYL + M40

MEDIO PESANTI - MEDIUM HEAVY - MITTEL SCHWERLAST - MI-LOURDES - MEDIO PESADOS

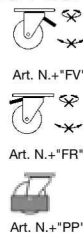
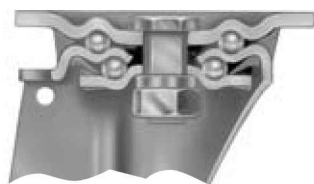

	D	100	100	100	125	125	125	150	175	200	
	E	30	40	40	30	40	40	40	40	50	

SUPPORTI GIREVOLI - SWIVEL CASTORS - LENKROLLEN - ROULETTES PIVOTANTES - CONJUNTOS GIRATORIOS

Art. N.	19603	19605	19606	19609	19610	19611	19616	19619	19621		
d	15	15	15	15	15	15	15	20	20		
Art. N.	19628	19630	19631	19634	19635	19636	19641	19644	19646		
d	15	15	15	15	15	15	20	20	20		
Art. N.	19653	19655	19656	19659	19660	19661	19666	19669	19671		
d	15	15	15	15	15	15	20	20	20		

SUPPORTI FISSI - FIXED CASTORS - BOCKROLLEN - ROULETTES FIXES - CONJUNTOS FIJOS

Art. N.	19678	19680	19681	19684	19685	19686	19691	19944	19946		
d	15	15	15	15	15	15	15	20	20		
Art. N.	19703	19705	19706	19709	19710	19711	19716	19969	19971		
d	15	15	15	15	15	15	20	20	20		
Art. N.	19728	19730	19731	19734	19735	19736	19741	19994	19996		
d	15	15	15	15	15	15	20	20	20		

DATI TECNICI - TECHNICAL DATA - TECHNISCHE DATEN - DONNÉES TECHNIQUES - DATOS TECNICOS

	H	137	137	137	163	163	163	194	237	249	
	AxB	105x85	105x85	135x110	135x110	105x85	135x110	135x110	135x110	135x110	
	axb	80x60	80x60	105x80	105x80	80x60	105x80	105x80	105x80	105x80	
	g	8	8	10	8	8	10	10	12	12	
	F	41	41	41	41	41	41	48	65	65	
	U	50	50	50	50	50	50	50	60	60	
	FR	FR	FR	FR	FR	FR	FR	FR	FR/FV	FR/FV	
	PP	-	-	-	PP	PP	PP	PP	PP	PP	
	Kg.	200	250	250	250	300	300	300	450	450	

ADINYL + M22

MEDI - MEDIUM - MITTELLAST - MOYENNES - MEDIOS



	D	80	100	100	125	125	150	150	175	200	
	E	24	30	30	30	30	40	40	40	50	

SUPPORTI GIREVOLI - SWIVEL CASTORS - LENKROLLEN - ROULETTES PIVOTANTES - CONJUNTOS GIRATORIOS

Art. N.	-	20005	20004	20007	20008	20010	20011	20014	20017		
d	-	15	15	15	15	15	15	20	20		
Art. N.	-	20030	20029	20032	20033	20035	20036	20039	20042		
d	-	15	15	15	15	20	20	20	20		
Art. N.	20052	20055	20054	20057	20058	20060	20061	20064	20067		
d	10	15	15	15	15	20	20	20	20		

SUPPORTI FISSI - FIXED CASTORS - BOCKROLLEN - ROULETTES FIXES - CONJUNTOS FIJOS

Art. N.	-	20105	20104	20107	20108	20110	20111	20114	20117		
d	-	15	15	15	15	15	15	20	20		
Art. N.	-	20130	20129	20132	20133	20135	20136	20139	20142		
d	-	15	15	15	15	20	20	20	20		
Art. N.	20152	20155	20154	20157	20158	20160	20161	20164	20167		
d	10	15	15	15	15	20	20	20	20		

SUPPORTI GIREVOLI A FORO - SWIVEL BOLT HOLE CASTORS - RÜCKENLOCH LENKROLLEN
ROULETTES PIVOTANTES A Oeil - CONJUNTOS GIRATORIOS CON TALADRO PASADOR

Art. N.	-	20205FB	20204FD	-	20208FD	-	20211FD	20214FE	20217FE		
Art. N.	-	-	-	-	-	-	-	20214FG	20217FG		
d	-	15	15	-	15	-	15	20	20		
Art. N.	-	20230FB	20229FD	-	20233FD	-	20236FD	20239FE	20242FE		
Art. N.	-	-	-	-	-	-	-	20239FG	20242FG		
d	-	15	15	-	15	-	20	20	20		
Art. N.	20252FB	20255FB	20254FD	-	20258FD	-	20261FD	20264FE	20267FE		
Art. N.	-	-	-	-	-	-	-	20264FG	20267FG		
d	10	15	15	-	15	-	20	20	20		

DATI TECNICI - TECHNICAL DATA - TECHNISCHE DATEN - DONNÉES TECHNIQUES - DATOS TECNICOS

	H	106	128	129	160	160	181	181	216	240	
	AxB	102x83	102x83	102x83	102x83	135x110	102x83	135x110	135x110	135x110	
	axb	80x60	80x60	80x60	80x60	105x80	80x60	105x80	105x80	105x80	
	g	8	8	8	8	10	8	10	10	10	
	g	FB=10-12			FD=12-14			FE=12-14 / FG=16-18			
	F	33	37	46	49	49	51	51	57	59	
	U	40	40	50	50	50	50	50	60	60	
	FR	FR	FR	FR	FR	FR	FR	FR	FR	FR	
	PP	-	-	-	PP	PP	PP	PP	PP	PP	
	Kg.	120	120	200	200	200	200	200	300	300	